

RUSTOMJEE
SUMMIT
BORIVALI (E)

IT'S THOUGHTFUL. IT'S **Rustomjee®**



MR. BOMAN R. IRANI

CHAIRMAN & MANAGING DIRECTOR - RUSTOMJEE

“It gives us immense pleasure to be back in Borivali with our latest residential project - Rustomjee Summit, with great views, thoughtfully designed homes and delightful amenities. We're happy to be home, because home is where our heart is.”



ANY WAY YOU LOOK AT IT,
THIS IS THE KIND OF PLACE YOU'D
BE PROUD TO CALL HOME.

*Located in the bustling suburb of Borivali East, Rustomjee Summit
offers you a lifestyle most people can only dream of.*

*A neighbourhood with every reason to step out, a home that you will
want to hurry back to. What's more, the Sanjay Gandhi National Park
is next door. Which means your kids can see animals for real,
rather than in a picture book.*



Artist's Impression



Artist's Impression



Artist's Impression

COSY, YET SPACIOUS.
AS CLOSE TO THE CITY AS IT IS AWAY FROM IT.
LUXURIOUS, BUT AFFORDABLE.
AREN'T CONTRADICTIONS LOVELY?

*Situated in Borivali (E), just minutes away from major arterial roads
such as the Western Express Highway, S.V. Road & Link Road,
Rustomjee Summit stands where two worlds meet.
Its thoughtfully designed 2 and 3 BHK homes, idyllic gardens,
and options to unwind, offer the best possible slice of city life in
a neighbourhood that gives you every reason to step out,
and a home that you will want to hurry back to.*

IN A CITY THAT
DOESN'T UNDERSTAND THE CONCEPT
OF PERSONAL SPACE,
PRESENTING A HOME THAT DOES.

PROJECT DETAILS

Thoughtfully designed 2 and 3 bedroom homes

Within easy reach of the Borivali East-West Flyover

*Excellent connectivity to the Western Railway,
proposed metro station and Western Express Highway*

Designer entrance lobby

Sky Garden

Kids' play area

Safety and security features

Intercom facility & CCTV

LIFESTYLE AMENITIES

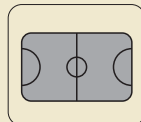

MULTI PLAY COURT



GYMNASIUM



MULTI FUNCTION
ROOM



SWIMMING POOL



INDOOR GAMES
ROOM



SEMI MODULAR
KITCHEN



VIDEO DOOR PHONE



CCTV IN SELECT
COMMON AREAS

FOR FRIDAY NIGHT PLANS,
A GETAWAY OR TRIPS WITHOUT TRAFFIC,
JUST STEP OUT.

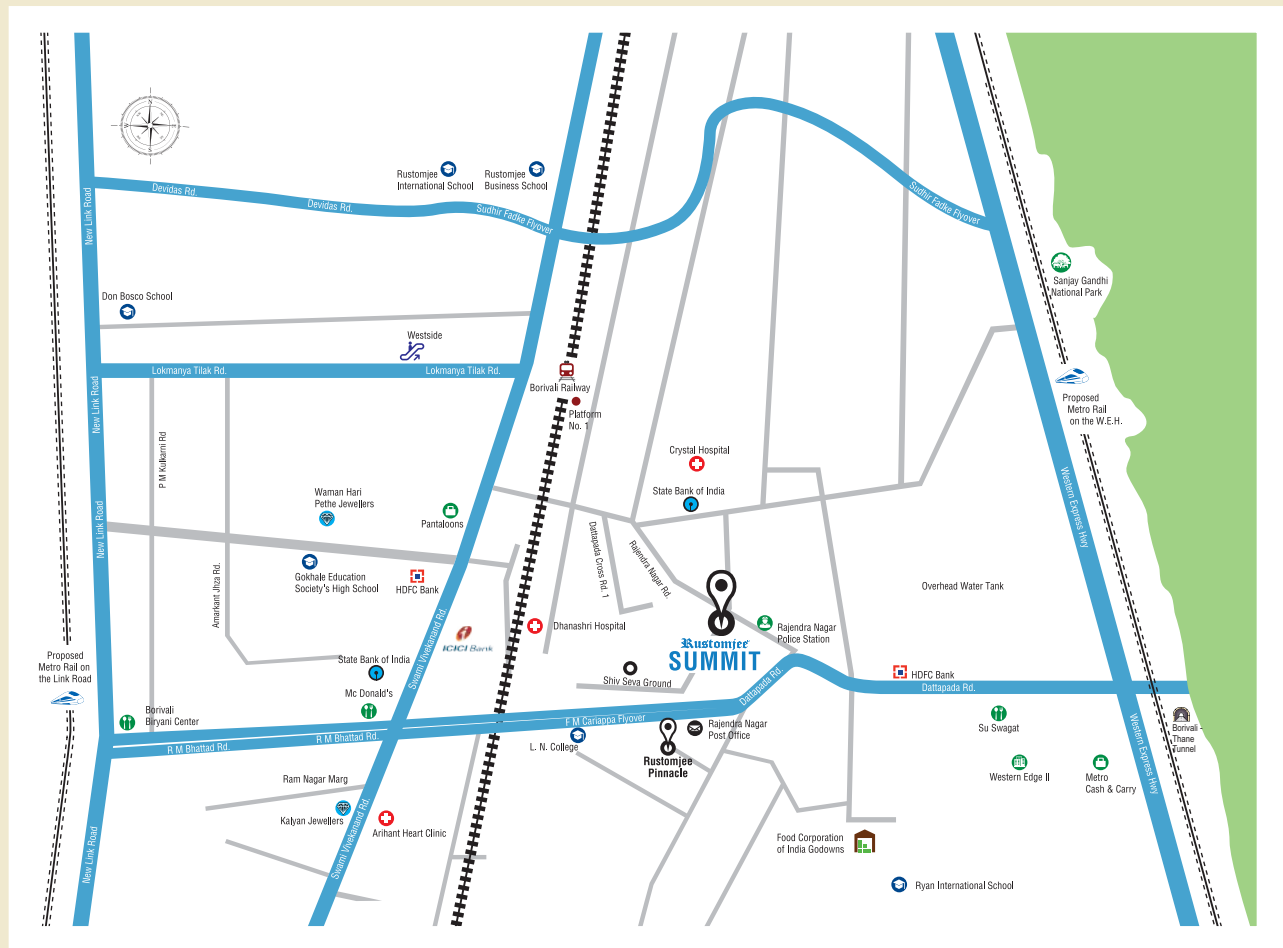

CONNECTIVITY

Western Express Highway | Link Road | S. V. Road | Borivali - Thane Tunnel

PROPOSED METRO STATION

At Western Express Highway and Link Road

EDUCATION

Rustomjee International School | Rustomjee Business School | Thakur School

Don Bosco School | Ryan International School | L. N. College

HEALTHCARE

Crystal Hospital | Dhanashri Hospital | Arihant Heart Clinic

RETAIL & ENTERTAINMENT

Westside | Pantaloons | Metro Cash and Carry | Western Edge 2

SANJAY GANDHI NATIONAL PARK

BORIVALI STATION



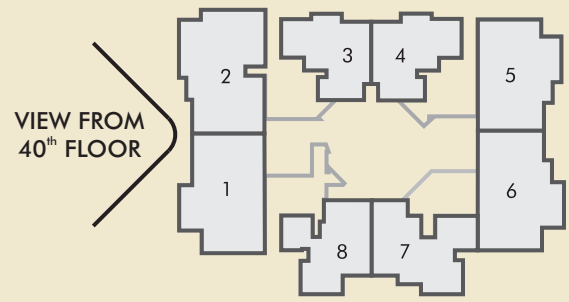

Shot at location



VIEW FROM
40th FLOOR

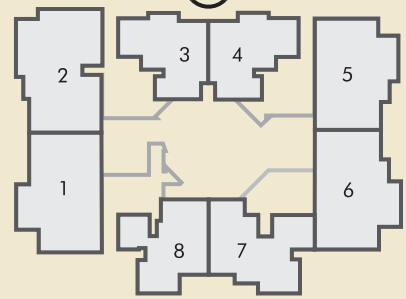

Shot of location



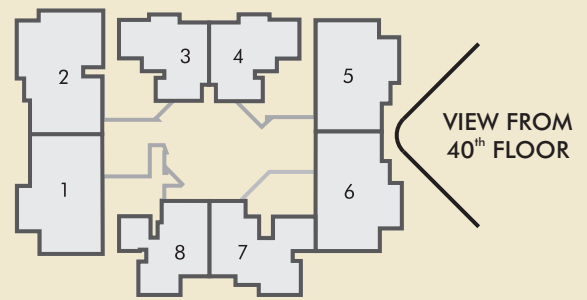



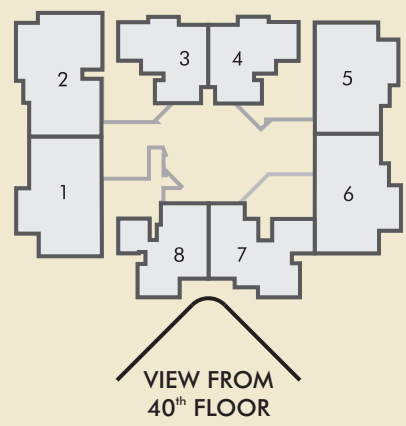

DESIGNER ENTRANCE LOBBY

Making the first impressions count.





Shot at location

FOR THE FORTUNATE FEW,
HAVING IT ALL IS JUST
A MATTER OF COMING HOME.

INTERNAL AMENITIES

*SEMI MODULAR KITCHEN | IMPORTED MARBLE IN LIVING AND
DINING AREAS AND PASSAGE | VITRIFIED TILES IN KITCHEN AND ALL BEDROOMS
CERAMIC TILES IN ALL TOILETS | LAMINATED FLUSH DOOR
PREMIUM CP FITTINGS - JAQUAR OR EQUIVALENT
AMERICAN STANDARD OR EQUIVALENT SANITARY WARE | VIDEO DOOR PHONE*

EXTERNAL AMENITIES

*SWIMMING POOL | GYMNASIUM | MULTI FUNCTION ROOM | INDOOR GAMES ROOM
LANDSCAPED GARDEN WITH MULTI PLAY COURT | CCTV IN KEY COMMON AREAS*



Shot at location

SWIMMING POOL

There's nothing a swim after hours can't undo.





Artist's Impression

MULTI FUNCTION ROOM

*It's Wednesday. There's a new season to binge watch. You
In case you needed an excuse to throw a party.*



got off early from work.



Artist's Impression

INDOOR GAMES ROOM

Give the neighbours a masterclass in competitiveness.





Artist's Impression

GYMNASIUM

The secret to loving what you see in your mirror: the treadmill



ill.



MULTIPLAY COURT

Your most important appointment of the day: football with



the kids.



Artist's Impression

ALFRESCO DINING

The view isn't the only thing that gets better, the higher you go.





Artist's Impression

STARGAZING DECK

Celebrate starry nights, a dinner date or just a quiet getaway



for two.



Artist's Impression

Notes: _____

This image shows a single sheet of white paper with horizontal blue ruling lines. The lines are evenly spaced and run across the width of the page. There are no margins, text, or other markings on the paper.

IT'S THOUGHTFUL. IT'S **Rustomjee®**

CALL: 022 6111 6111 | WWW.RUSTOMJEE.COM

SITE ADDRESS: RAJENDRA NAGAR, DATTAPADA ROAD, NEAR BORIVALI EAST-WEST FLYOVER,
BORIVALI (E), MUMBAI-400 066.

Disclaimer: The plans, specifications, images and other details depicted herein are only indicative and the Promoter reserves the right to change any or all of these in the interest of the development as per applicable rules and regulations. It does not constitute an offer and/or contract of any type between the Promoter and the recipient. Any prospective sale shall be governed by the terms and conditions of the agreement for sale to be entered into between the parties and recipient shall refer the MahaRERA Project site for complete details. The property is mortgaged with ICICI Bank Limited. The No Objection certificate (NOC)/ permission of the mortgagee Bank would be provided for sale of flats/units/property, if required.



MahaRERA Registration No: P51800003590. Available on the website: <http://maharera.mahaonline.gov.in>.

